

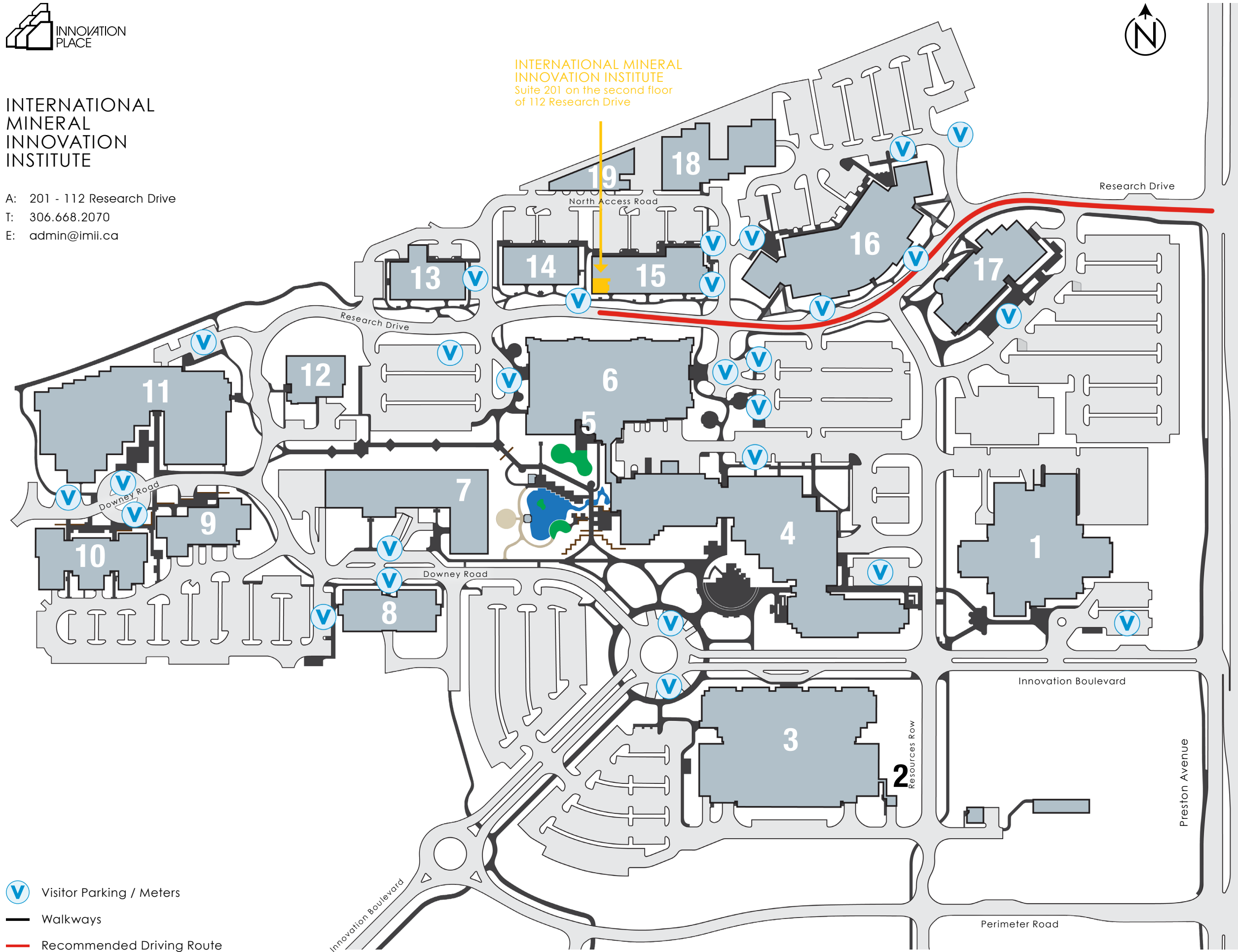

# INTERNATIONAL MINERAL INNOVATION INSTITUTE

A: 201 - 112 Research Drive  
T: 306.668.2070  
E: admin@imii.ca

INTERNATIONAL MINERAL INNOVATION INSTITUTE  
Suite 201 on the second floor of 112 Research Drive



1. National Hydrology Research Centre  
11 Innovation Boulevard
2. Canadian Space Agency  
305 Resources Row
3. SED Systems Inc.  
18 Innovation Boulevard
4. The Galleria  
15 Innovation Boulevard
5. Boffins Public House  
106 - 111 Research Drive
6. The Atrium  
111 Research Drive
7. SRC Analytical Laboratories  
422 Downey Road
8. Dr. Jack McFaul Building  
421 Downey Road
9. 411 Downey Road
10. Dr. Burton Craig Building  
407 Downey Road
11. L.F. Kristjanson Biotechnology Complex  
West - 410 Downey Road  
East - 106 Research Drive
12. Bio Processing Centre  
107 Research Drive
13. 108 Research Drive
14. 110 Research Drive
15. 112 Research Drive
16. The Concourse  
116 Research Drive
17. 121 Research Drive
18. Maintenance / Energy Centre  
1 North Access Road
19. 3 North Access Road

- Visitor Parking / Meters
- Walkways
- Recommended Driving Route

